

The Right Plaster for Every Surface



عمان

Gyprich One Coat Plaster High Purity 97%+

Good Strength, Pure White and Long Setting

Direct Coat is specially formulated gypsum Plaster, which can be hand applied over normal bare brick walls, hollow concrete blocks, columns, R.C.C. ceiling and solid backgrounds, in single application in normal thickness, Good surface finish and Good impact strength are its unique properties, Direct Coat plaster is premix single application plaster made from calcium sulphate hemi hydrate to which additives have been added to improve work ability, This light weight plaster is manufactured in an automatic continues flow kettle under a controlled temperature. This range of plaster comprises Direct Coat and Direct Coat Supreme, they are recommended to use depending upon the type of Back Ground

GYPRICH PRODUCTS

- Natural Gypsum Plaster
- One Coat Plaster
- Stucco Plaster
- Casting Plaster
- Pearlite Plaster
- Vermiculite Plaster
- Venire Plaster
- Plaster of Paris

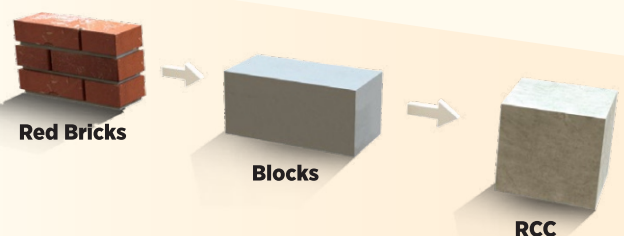

Gyprich One Coat Plaster



Material, Fields of Application, Properties

Description	Features	Self Life
Gypsum plaster for direct application on Interior brick walls and finishing layers on Concrete and cement surfaces.	<ul style="list-style-type: none"> * Free of shrinking cracks * No Need of water curing * Compatible with all types of paints * Environmental friendly 	Gyprich One Coat Plaster has a self life of approximately 1 year from the production date when stored Correctly.
	<ul style="list-style-type: none"> * Superior whiteness * Affordable & Cost effective * Zero Maintenance 	<div>Storage Condition</div> <p>Must be stored in dry condition</p>

Application Method

- * Gyprich One Coat Plaster should be mixed with clean water until desired consistency is achieved
- * Substrate surfaces must be stable, dry, level, and free of grease and dust
- * Apply the plaster mortar in order to create a level surface
- * Spread the applied material flush with a straight edge
- * After initial setting has commenced, level the surface and align the corners
- * If required slightly dampen the plaster surface to remove any minor unevenness
- * Once the plaster surface has set, smoothen with finishing trowel
- * For application on interior surface only

Application Fields

- * Brick Walls
- * Concrete Surfaces
- * Hollow Concrete Block
- * R.C.C. Ceiling



Higher setting time



Lower Density



No Repairing cost



Low Wastage



50% Higher Productivity



Green Product Certified

Advantages of Gyprich One Coat Plaster

	Direct Application	Line & Level	Smooth Finish	Time Saving	Quality Assurance	Water Curing	Shrinkage Cracks	Consumption of Paint
Gyprich One coat plaster	✓	✓	✓	✓	✓	Doesn't Require	Doesn't Occur	Low
Sand Cement Plaster	✓	✗	✗	✗	✗	Needed	High Risk	High

Gyprich

TECHNICAL SPECIFICATION	Direct Coat	Casting Plaster	Spray Machine Plaster
Appearance	Crystal White	Crystal White	Crystal White
Initial Setting Time	15- 25 Minutes	12- 15 Minutes	90- 120 Minutes
Pot Life	25-30 Minutes	18-20 Minutes	150-180 Minutes
Coverage and thickness of 10 MM	16-18 Sq Ft Bag of 25 Kg	16-18 Sq Ft Bag of 25 Kg	16-18 Sq Ft Bag of 25 Kg
Workability	Easy	Easy	Easy
Compressive Strength (kg/cm)	75-80	75-80	75-80

The Single Substitute of Sand Cement & Curing for Interior Constructions

Gyprich One Coat Plaster

Powder Type : Gypsum Plaster

Row	Tests		Limit	Result
1	Chemical Test	So3 (%)	> 47%	≈ 52.5%
		SiO2	-	≈ 1.0%
		A12O3	-	≈ 1.5%
		MgO	-	≈ 0.6%
		K2O	-	≈ 0.16%
2	Set Time	Initial	7-12 min	13
		Final	→ 25 min	27
3	Sieve Analyses [% remaining]	200 mesh	< 5%	< 1%
4	Free water		<1%	<1%
	Chemical water		4-6%	5%
	Crystal water at time		20%	20%
	Purity			95
	Impurities		-	<5%
5	Compressive strength (N/mm2)		6	≈ 10
	Bending strength (N/mm2)		2.5	≈ 4



Gyprich One Coat Plaster



Benefits of Gypsum Plastering

Benefits of Gypsum Plastering Over Sand Cement Plaster

Faster Construction

Sand Cement plaster requires 28 days of water curing and then the surface is smoothened with POP punning which again requires time. With Gypsum plaster you finish your walls and the surface is paint ready within 3 days (days required for complete drying).

Reduced Dependency on River Sand

Gypsum plaster comes in ready to use bags. Just add water and you are good to go. River sand mining is environmentally harmful and thus banned in many states. Gypsum plaster provides you with best alternative to usage of river sand for all your internal plastering applications.

Water Curing

Sand Cement Plaster requires water for curing of the tune of 0.6 kg/m²/day. So supposing a project of 1,00,000 sq-m you require water of tune of 60000 liters daily. And given that minimum curing time of Sand Cement plaster is 28 days, the quantity multiplies manifold. Gypsum plaster gives you freedom from water curing thus saving your cost as well as environment.

Shrinkage Cracks Elimination

Shrinkage cracks are a major problem in Sand Cement plaster which is caused due to high heat of hydration and improper curing. Gypsum plaster doesn't have these problems and hence the walls are free from shrinkage cracks.

Lighter Building Construction

Density of Gypsum plaster (700 kg/m³) is more than 50% less as compared to traditional Sand cement plaster (1860 kg/m³). Hence usage of Gypsum plaster for wall plastering decreases the structural load on the building.

Note:

Please contact our sales department for inquiries about storage and Packing.



Clean and Wet

Clean and pre wet the wall before application



Mixing

Mix Powder in water

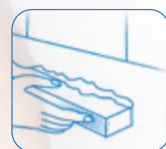

Levelling

Level the material paste on the wall with the help of aluminum box plate



Finishing

Mix thin slurry & apply on levelled surface with trowel to get smooth finish



Drying

Leave the wall to dry for 2-3 days

Omano Fortune Group.FZCO	Marketed by HELEN GROUP, Vizag	Omano
#101, Building A2, Silicon Oasis, Dubai, UAE Mob: +971 585874599 info@omanofortune.com	Disclaimer:	
www.omanofortune.com	The constructional and structural properties, and characteristic building physics Omano Fortune Group can solely be ensured with the exclusive use Omano Fortune Group Components, or other Product expressly recommended by Omano.	